

DESCRIPTION

The YC-822 is a indoor wall-mount box.

SPECIFICATIONS

Finish	Surface-treated steel plate, off-white
Dimensions	124 (W) × 124 (H) × 61 (D) mm (4.88" × 4.88" × 2.4")
Weight	400 g (0.88 lb)
Accessory	Wall mounting screw ×4

APPEARANCE

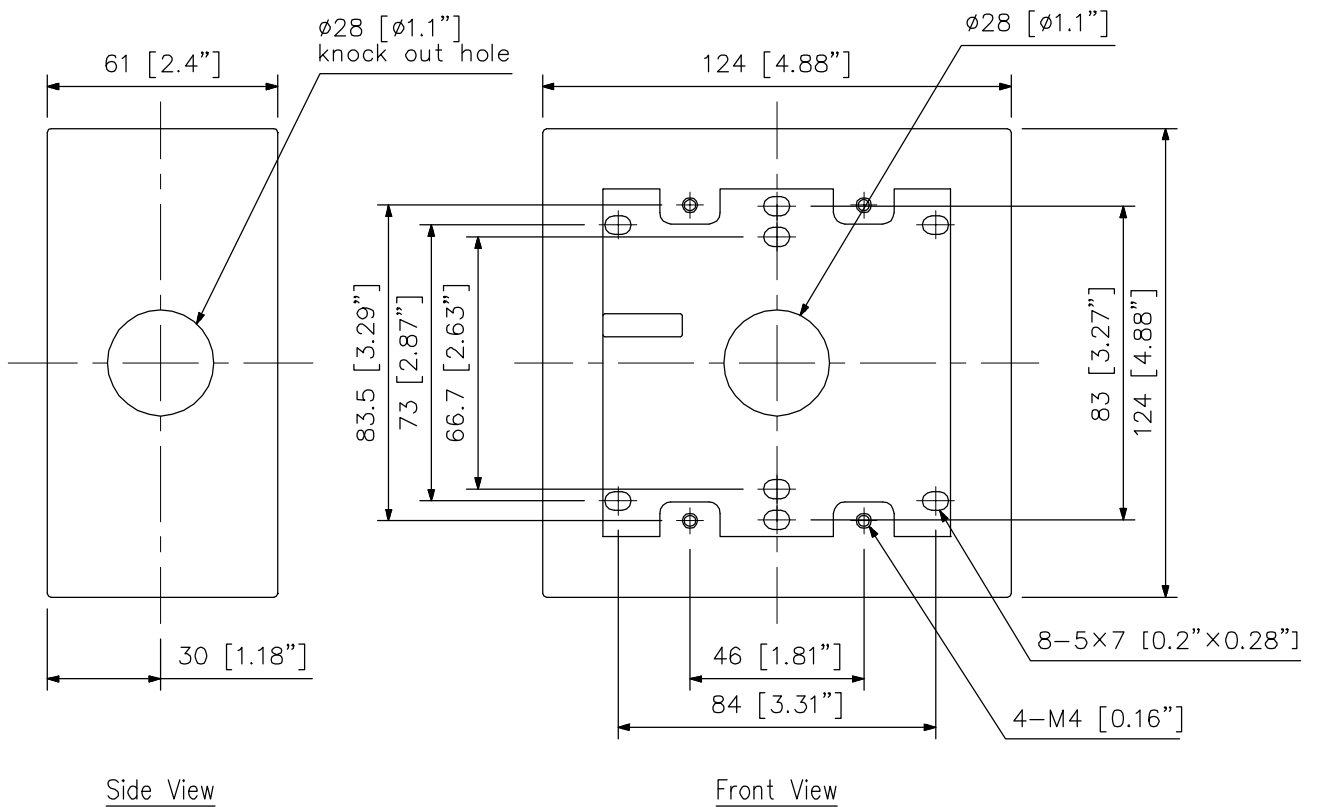

UNIT: mm SCALE: 1/2